

Wall Mounting Kit

TSP-WMK02

| Order Code | TSP-WMK02 |
|-------------------|--|
| Compatible with | TSP 360, TSP 360WR, TSP-3P 480, TSP 600, TSP 600WR, TSP-3P 960, TSPC 480 |
| Mounting Kit Type | Wall Mounting Kit |
| Package content | 2x Bracket |
| Material | Zinc clear |
| Weight | 40 g |
| RoHS Exemptions | No Exemptions |



Outline Dimensions

Mechanical Drawing

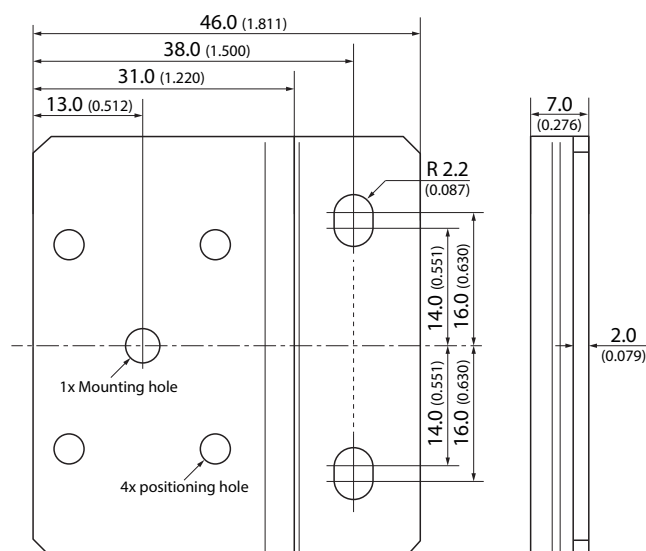

All dimensions in mm (inch)
Tolerance: ± 0.3 (± 0.012)

Max. screw insertion depth

| Series | Max. screw insertion depth | Series | Max. screw insertion depth |
|------------|----------------------------|----------|----------------------------|
| TSP 360 | 3.5 mm (0.138 inch) | TSP 960 | 5 mm (0.197 inch) |
| TSP 360-EX | | TSPC 480 | |
| TSP 480 | | | |
| TSP 600 | 5 mm (0.197 inch) | | |
| TSP 600-EX | | | |
| TSP 600 WR | | | |

The screw insertion depth is referenced from the outside surface of the chassis.

Mounting screw type: M4 machine screw, DIN 7985. The use of washers can serve as an anti-vibration measure.

Note: To prevent damage to the device, do NOT exceed maximum screw insertion depth.

Note: Ensure the device is disconnected from supply before fitting wall mount.